

Cutting machine for bars

Tom Claes & Chiel Welz

Specialization Electromechanical Engineering Technology

Company

Esma is located in Maaslechelen, Belgium. Specialised in hinge technologies and product development adapted to customer demand.

Situation

The company has an outdated cutting machine with the task of cutting bars with different diameters (5 to 9 mm) to size.

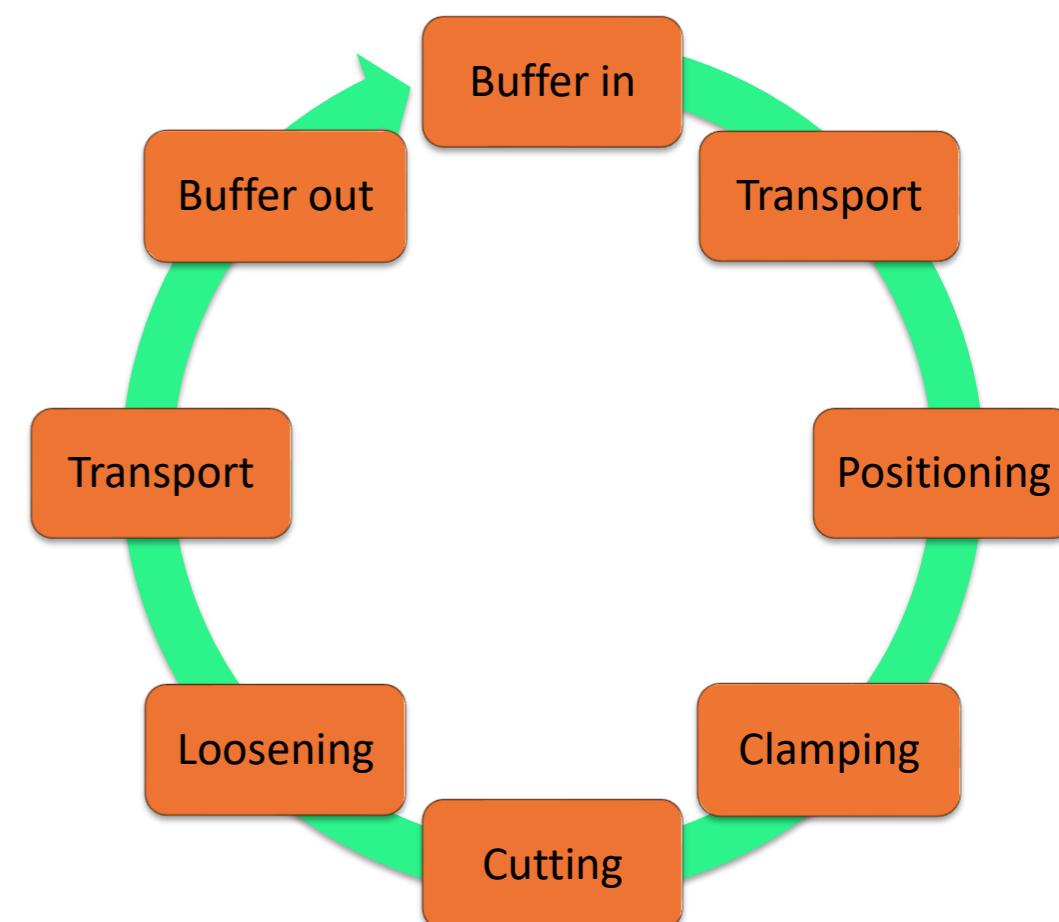
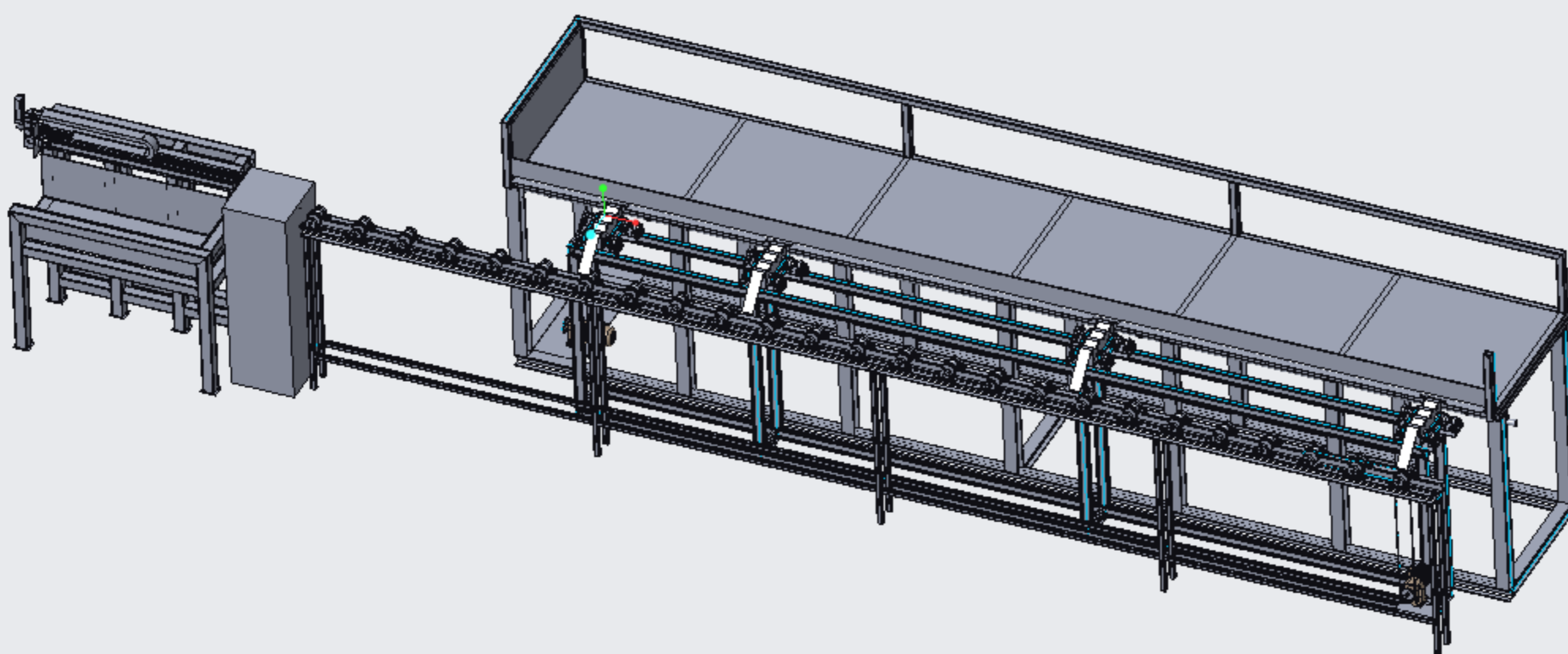

Objectives

- ✓ Adjustable length for different diameters
- ✓ Tolerances cut bar: 0, - 0.5 mm
- ✓ Length of supply at least 6 metres
- ✓ Maximum cutting length = 1300 mm
- ✓ Reuse existing cutting mechanism

The principle

First the buffer will be filled with bars. Then these bars will be transported one by one via a walking beam and a transport system to the cutting mechanism. After cutting, the cut parts are removed from the mechanism and placed in a container.

Supervisors / cosupervisors:

Prof. Dr. ir. M. Daenen
Prof. Dr. Ing. K. Kellens

Dr J. Lievens
Ing. J. Bijmens